

KP290-6UL-C

- 6" swivel
- Anti-friction roller bearings
- Paythane polyurethane on cast iron

KP290/KP291

KINGPINLESS SERIES

The "KP290" is designed for heavy shock loads and punishing service in heavy medium applications.

Applications:

For equipment in the range of 1500 to 5000 lbs. Large wheel selection allows for a variety of applications. Suited for rough conditions. Used on warehouse trucks, refuse containers, cargo containers, heavy platform trucks, building material carts, etc.

Standard Features/Components:

- 3/8" hot forged steel top plate.
- 1/4" hot forged steel legs.
- Precision ball bearing raceways provide better swiveling and durability under extreme loads.
- Double-welded legs for added strength.
- Grease fittings in axle and swivel bearings.
- Zinc plated finish.

Raceway Construction:

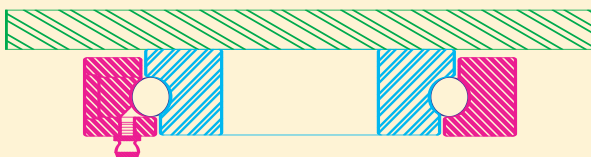

KP291-6UM

- 6" rigid
- Anti-friction roller bearings
- Plexite phenolic wheel

Wheels & Optional Extras:



Miratek
95 duro. red polyurethane



Plexite Phenolic
macerated canvas backing

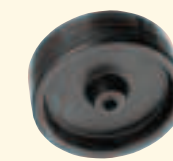

Peejay
polyolefin plastic



Payron Semi-Steel
high tensile sintered iron



V-groove
machine grooved steel

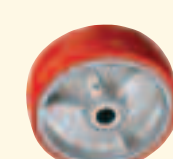

Paythane
polyurethane bonded to a metal center



WK Brake
locks wheel, not used with Thread Guards, swivel only



WS Wheel Seals
locks out foreign matter

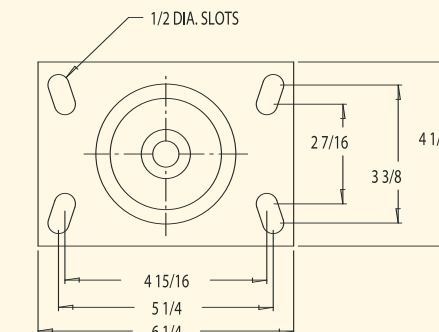

Top Plate C
Suffix-C

KP290 SWIVEL & KP291 RIGID SPECIFICATIONS											
WHEEL SPECIFICATIONS				CATALOG NUMBER				Approx. Weight lbs	Swivel Radius inches	Height Over-All inches	Top Plate inches
Diameter inches	Width inches	Type	Cap Each lbs	Swivel Plain, Oilite Bearings	Roller Bearings	Rigid Plain, Oilite Bearings	Roller Bearings				
4	2	Payron	850	KP290-40S	KP290-4US	KP291-40S	KP291-4US	6 1/2	3%	5%	Width by Length: 4 x 4 1/2
		Plexite	900		KP290-4UM		KP291-4UM	5			
		Miratek	500		KP290-4UT		KP291-4UT	6			
		Paythane	800		KP290-4UL		KP291-4UV	6			
		Peejay	550	KP290-4PJ	KP290-4UJ	KP291-4PJ	KP291-4UJ	4 1/4			
5	2	Payron	1050	KP290-50S	KP290-5US	KP291-50S	KP291-5US	7 1/2	4%	6 1/2	
		Plexite	1000		KP290-5UM		KP291-5UM	5 1/2			
		Miratek	700		KP290-5UT		KP291-5UT	7			
		Paythane	1000		KP290-5UL		KP291-5UV	7			
		Peejay	650	KP290-5PJ	KP290-5UJ	KP291-5PJ	KP291-5UJ	4 1/2			
6	2	Payron	1100	KP290-60S	KP290-6US	291-60S	KP291-6US	9	4 3/4	7 1/2	
		Plexite	1050		KP290-6UM		KP291-6UM	7			
		Miratek	820		KP290-6UT		KP291-6UT	7			
		Paythane	1100		KP290-6UL		KP291-6UV	6			
		Peejay	1200	KP290-6PJ	KP290-6UJ	KP291-6PJ	KP291-6UJ	6			
8	2	V-Groove	1100		KP290-6USG		KP291-6USG	11	5%	9 1/2	
		Payron	1200	KP290-80S	KP290-8US	KP291-80S	KP291-8US	12 1/2			
		Plexite	1200		KP290-8UM		KP291-8UM	8 1/2			
		Miratek	1000		KP290-8UT		KP291-8UT	7			
		Paythane	1200		KP290-8UL		KP291-8UV	7			
Peejay	1000	KP290-8PJ	KP290-8UJ	KP291-8PJ	KP291-8UJ	7					
V-Groove	1200		KP290-8USG		KP291-8USG	13 1/2					

• Weights shown represent swivels, rigid casters weigh approximately 15% less. Option: For brakes, add suffix -WK.