

**071-5UM**

- 5" rigid
- Anti-friction roller bearing
- Plexite phenolic wheel

**070/071** SANITARY CASTERS  
**MEDIUM DUTY**

The 070 is a high quality precision swivel caster with two separate, large diameter ball bearing raceways. Construction is of heavy gauge cold-rolled steel, embossed for additional strength and style.

**Applications:**

For equipment in the range of 500 to 2000 lbs. A versatile caster of wide usage on both institutional and industrial platforms where precise operation is required.

**Engineering Data:**

- .225 top plate.
- One-piece .149 wrap-around bracket staked to .165 top cup.
- 5/8" hydraulically upset kingpin.
- .149 bottom cup.
- Case hardened.

**Standard Features/Components:**

- Zinc plated finish.
- Lubrication fittings for swivel and wheel.
- 1/2" axles for 5 & 6" models.
- 3/8" axles for 4" models.
- 5/8 x 1/2 x 2" hardened spanners for 5 & 6" models.
- 1/2 x 3/8 x 1 1/8" hardened spanners for 4" models.

**Raceway Construction:**

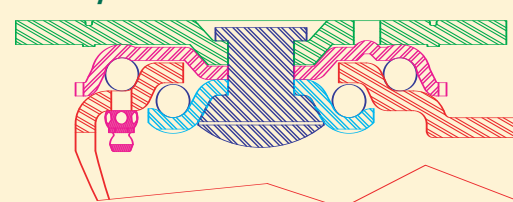

**070-5UV**

- 5" swivel
- Anti-friction roller bearing
- Bronco molded rubber on aluminum core wheel

**070 Swivel Stems:**

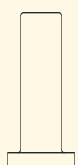

**073 Round Stem**  
3/4 x 2 1/2"  
See page 65.



**074 Threaded**  
3/4 - 10 x 2 1/2"  
5/8 - 11 x 2" option  
See page 67.



**076 Octagon**  
3/4 x 2 1/8"  
See page 71.

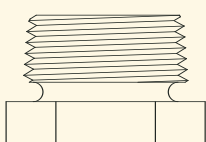

**075 Pipe Tapered Thread**  
1/4 NPT, 1 NPT  
(National Pipe Thread, Nominal Dimen.) See page 69.

To order a stem caster, change the first three digits of the model number to one of the three prefixes listed. Example: the 070-4UM becomes a threaded stem caster by eliminating the 070 and adding 074, i.e. 074-4UM. Rigid Stem Casters available.

**Wheels & Optional Extras:**

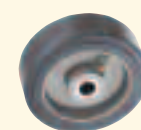

**Bronco Mold-On**  
rubber bonded to aluminum center

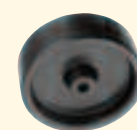

**Peejay**  
polyolefin plastic



**Plexite Phenolic**  
macerated canvas



**Payron Semi-Steel**  
high tensile sintered iron

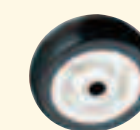

**Mirakush**  
85 duro. gray polyurethane



**Miratek**  
95 duro. red polyurethane



**Payflex Soft Rubber**  
non-marking tread



**V-groove**  
machine grooved steel



**Payrock Hard Tread**  
rubber fibrous compound



**SK Brake**  
locks wheel & swivel simultaneously. Available: 5, 6" wheels only

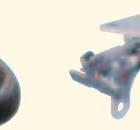

**SL 4-Position Swivel Lock**  
plunger engages at 90° angles



**SS Swivel Seal**  
Neoprene seals protect swivel raceways



**WS Wheel Seals**  
locks out foreign matter



**TG Thread Guards**  
cannot be used with WK brakes



**WK Brake**  
locks wheel, not used with Thread Guards, swivel only

070 SWIVEL & 071 RIGID SPECIFICATIONS											
WHEEL SPECIFICATIONS				CATALOG NUMBER				Approx. Weight lbs	Swivel Radius inches	Height Over-All inches	Top Plate inches
Diameter inches	Width inches	Type	Cap Each lbs	Swivel Plain, Oilite, Delrin Bearings		Rigid Plain, Oilite, Delrin Bearings					
4	1 1/2	Payron	600	070-4PS	070-4US	071-4PS	071-4US	4 3/4	3 1/16	5 1/4	Width by Length: 3 3/4 x 4 5/8
		Payflex	250	070-40X		071-40X					
		Payrock	400	070-40H		071-40H					
		Bronco	300		070-4UV		071-4UV				
		Plexite	600	070-4DM	070-4UM	071-4DM	071-4UM	3 3/4			
		Mirakush	300	070-4DK	070-4UK	071-4DK	071-4UK				
		Miratek	400	070-4DT	070-4UT	071-4DT	071-4UT				
		Peejay	400	070-4PJ		071-4PJ					
V-Groove	800		070-4USG		071-4USG						
5	1 1/2	Payron	600	070-50S	070-5US	071-50S	071-5US	5 3/4	4 5/16	6 5/16	Bolt Hole Spacing: 2 5/8 x 3 3/8 slotted to 3 x 3
		Payflex	270	070-50X		071-50X					
		Payrock	400	070-50H		071-50H					
		Bronco	325		070-5UV		071-5UV				
		Plexite	600	070-5DM	070-5UM	071-5DM	071-5UM	4 1/2			
		Mirakush	350	070-5DK	070-5UK	071-5DK	071-5UK				
		Miratek	500	070-5DT	070-5UT	071-5DT	071-5UT				
		Peejay	450	070-5PJ		071-5PJ					
6	1 1/2	Payflex	290	070-60X		071-60X		5	4 1/16	7 1/16	Size of Bolt Holes: 2 5/16
		Payrock	430	070-60H		071-60H					
		Bronco	350		070-6UV		071-6UV				
		Plexite	800	070-6DM	070-6UM	071-6DM	071-6UM				
		Mirakush	420	070-6DK	070-6UK	071-6DK	071-6UK				
		Miratek	560	070-6DT	070-6UT	071-6DT	071-6UT				

• Weights shown represent swivels; Rigid casters weigh approximately 15% less.

Red = P.D.Q. (2 days or less)