

**010-20X-ZP**

- 2" swivel
- Oilite bearing
- Payflex cushion tread wheel

**012-20H-ZP**

- 2" swivel stem
- Oilite bearing
- Payrock hard tread wheel
- Comes with "H1" Socket

**010-017**SANITARY  
CASTERS**LIGHT DUTY**

Strength, style, economy, and versatility render the 010 the most popular light duty series in the industry. The strength is derived from a precision double ball bearing swivel design, with all components heat-treated for longer service.

Specifically, the  $\frac{3}{8}$ " kingpin, the  $\frac{3}{16}$ " ball bearings, and the  $\frac{5}{16}$ " riveted axle are larger than conventional models.

Standard plating is Zinc, although Bright Chrome, English Bronze, and Bright Brass finishes are available. Please specify finish via the suffix letter.

A variety of stem and plate sizes listed makes the 010 Series truly a versatile caster. An economical price results from an automated production line with the finest tooling. Payflex and Mirakush wheels afford complete floor protection, while the Payrock and Peejay add up to higher capacities and carpet usage. WK brakes are available. No rigid models.

**Finishes Available:**

The ZP (Zinc Plated) finish is standard. Please use suffix letters to specify the proper finish.

ZP = Zinc Plated      BC = Bright Chrome  
EB = English Bronze      BB = Bright Brass

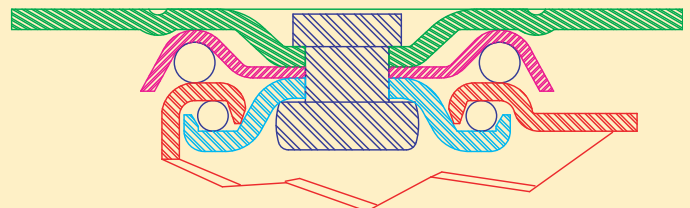
**Raceway Construction:**

## Wheels & Optional Extras:



**Peejay**  
polyolefin plastic

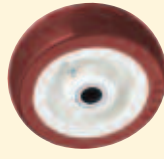

**Miratek**  
95 duro. red polyurethane



**Payflex Soft Rubber**  
non-marking tread



**Payrock Hard Tread**  
rubber fibrous compound



**Mirakush**  
85 duro. gray polyurethane



**WK Brake**  
locks wheel, not used with Thread Guards, nut & bolt axle furnished

## Plate & Stems:

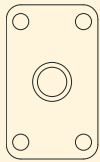

**010 Plate**  
2 x 1 3/8"; 1 1/8 x 1 3/8" spacing, 3/16" holes

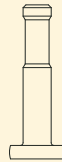

**012 Grip Neck**  
5/16 x 1 1/2"

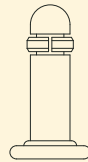

**003 Ring Ret**  
7/16 x 1 1/2" x 3/8 x 1"



**014 Threaded**  
5/16 - 18 x 1 1/2" x 3/8 - 16 x 1 1/2"

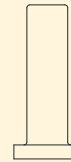

**017 Plain Round**  
7/16 x 1 1/2"  
For use in "PS" Sockets

## Sockets:



**"HI" Socket**  
For use with "012" Stem in wood with 3/8" I.D. hole

Use with 012 Grip Neck



**00437-PB-2H**  
Socket with 2 each .295 holes for wood attachment



**00437-PB Inside 90**  
Socket with 2 each .295 holes. Bolt or weld to attach.

Use with 013 Ring Ret.



**00437-PB-Outside 90**  
Socket with 2 each .295 holes. Bolt or weld to attach.



**00870 - PS**  
Socket for 1 x 16" gauge tubing of 7/8" I.D.

Use with 017 Plain Round



**00906 - PS**  
Socket for 1 x 18" gauge tubing of 29/32" I.D.

010-017 SERIES SPECIFICATIONS											
WHEEL SPECIFICATIONS					CATALOG NUMBER						
Diameter inches	Width inches	Type	Cap Each lbs	Height Less Stem*	Top Plate 2 x 1 3/8 plate 1 1/8 x 1 3/8 holes	Grip Neck Stem 5/16 x 1 1/2	Ring Ret. Stem 7/16 x 1 1/2	Ring Ret. Stem 3/8 x 1	Threaded Stem 5/16 - 18 x 1 1/2	Threaded Stem 3/8 - 16 x 1 1/2	Round Stem 7/16 x 1 1/2
2	7/8	Payflex	75	2 3/4	010-20X	012-20X	013-20X	Z013-20X	014-20X	Z014-20X	017-20X
		Payrock	100		010-200H	012-20H	013-20H	Z013-20H	014-20H	Z014-20H	017-20H
		Peejay			010-2PJ	012-2PJ	013-2PJ	Z013-2PJ	014-2PJ	Z014-2PJ	017-2PJ
2 1/2	7/8	Payflex	100	3 1/4	010-2 1/2 OX	012-2 1/2 OX	013-2 1/2 OX	Z013-2 1/2 OX	014-2 1/2 OX	Z014-2 1/2 OX	017-2 1/2 OX
		Peejay	110		010-2 1/2 PJ	012-2 1/2 PJ	013-2 1/2 PJ	Z013-2 1/2 PJ	014-2 1/2 PJ	Z014-2 1/2 PJ	017-2 1/2 PJ
3	1 3/16	Payflex	100	3 1/2	010-30X	012-30X	013-30X	Z013-30X	014-30X	Z014-30X	017-30X
		Peejay	125		010-3PJ	012-3PJ	013-3PJ	Z013-3PJ	014-3PJ	Z014-3PJ	017-3PJ
	Mirakush		010-3DR		012-3DR	013-3DR	Z013-3DR	014-3DR	Z014-3DR	017-3DR	
	Miratek	145	010-3DF		012-3DF	013-3DF	Z013-3DF	014-3DF	Z014-3DF	017-3DF	

Please use SUFFIX LETTERS for the proper finish, e.g. 017-20X-BC. If SUFFIX LETTERS are not shown, the ZP (Zinc Plated) finish will be automatically supplied.

Overall Height of 010 Series is approximately 1/16" greater than shown for Stem Models.

"HI" Sockets are automatically furnished with any "012" Order.